

POLYSTORM CELL
Product Code: PSM3

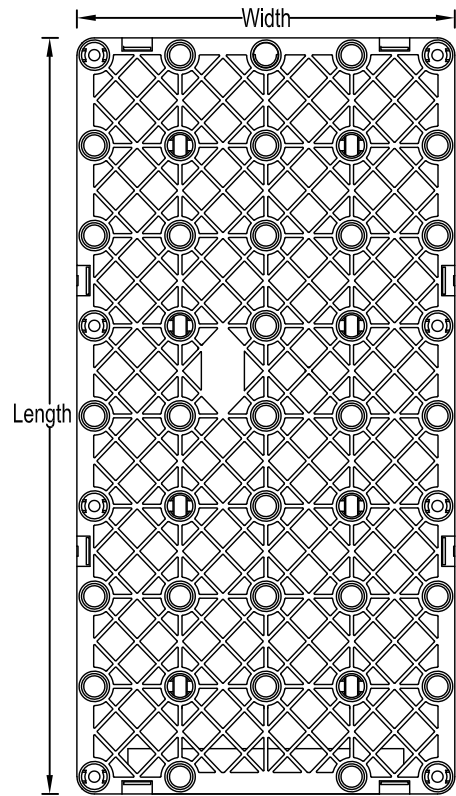

PLAN VIEW
Scale 1:10

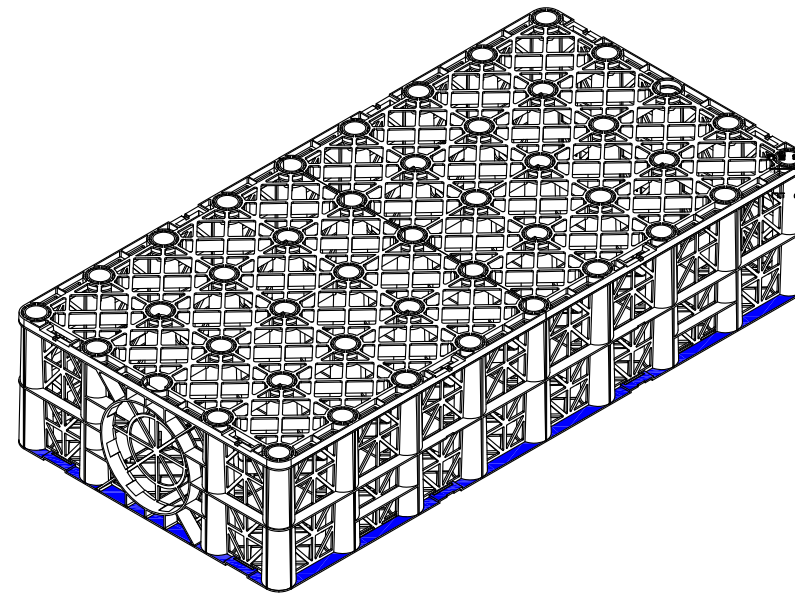

ISOMETRIC VIEW
Scale 1:10

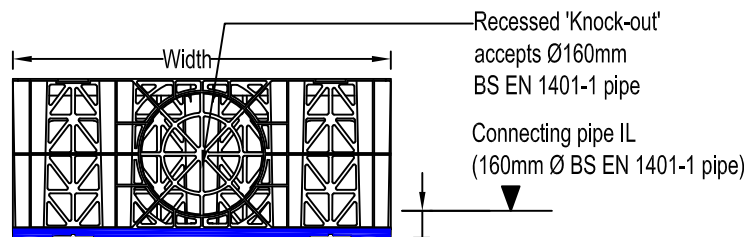

END ELEVATION
Scale 1:10

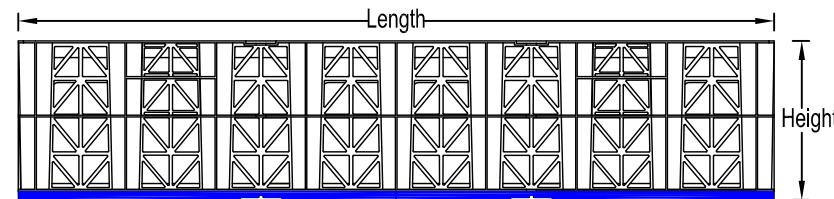

SIDE ELEVATION
Scale 1:10

POLYSTORM TABLE									
NAME	CODE	LENGTH (mm)	WIDTH (mm)	HEIGHT (mm)	A (mm)	VERTICAL STRENGTH (kN/m ²)	LATERAL STRENGTH (kN/m ²)	COLOUR	MATERIAL
Polystorm Xtra	PSM3	1000	500	210	36	834	93	Grey	Prime Polypropylene

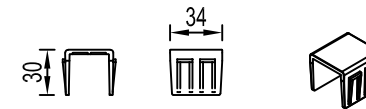

POLYSTORM CLIP
Scale 1:5

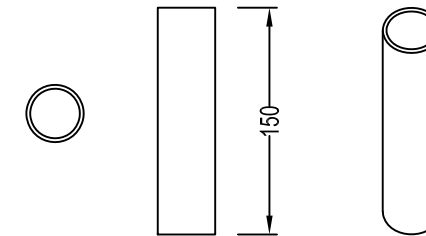

POLYSTORM SHEAR CONNECTOR
Scale 1:5

POLYSTORM SYSTEM NOTES

- Polystorm units are available with either a Ø225mm or Ø300mm Ridgidrain socket upon request. Please refer to:- PSM_SD_005

NOTES

- All dimensions in millimetres, unless otherwise stated.
- All dimensions are nominal and may vary within manufacturing or construction tolerances.
- All site temporary and enabling works by others.
- Polypipe products to be installed in accordance with Polypipe civils recommendations (refer to Polypipe technical guidance for further information), giving due consideration to the requirements of the organisation who will be taking ultimate ownership of the installation.
- This drawing is intended for guidance only. Confirmation of the information contained within this document should be sought from the consulting engineers before final design or construction activities commence.

All information in this document is of an illustrative nature and is supplied by Polypipe Civils & Green Urbanisation without charge. Polypipe may modify and change the information, products and specifications from time to time for a variety of reasons, without prior notice. Updates will not be issued automatically. This information is not intended to have any legal effect, whether by way of advice, representation or warranty (express or implied). We accept no liability whatsoever (to the extent permitted by law), if you place any reliance on this document you must do so at your own risk. The information within this document should not be solely relied upon to determine the suitability or installation requirements of our products for a proposed application and expected site conditions; expert advice should be sought in this respect. Copyright © 2020 Polypipe. All rights reserved. 'Polypipe logo' is a registered trademark of Polypipe. All Polypipe products are protected by Design Right under CDPA 1988.



Polypipe Civils & Green Urbanisation

North Road, Loughborough, Leicestershire, LE11 1LE
Tel: 01509 615100
Fax: 01509 615215
www.polypipe.com/civils

PROJECT	POLYSTORM STANDARD DETAILS		STATUS	
			FOR INFORMATION	
TITLE	POLYSTORM XTRA GEOCELLULAR COMPONENT		DATE	DRAWN BY
			17/03/16	JL
			ORIGINAL SIZE	SCALE
		A3	AS SHOWN	
		DRAWING No.	REV.	
		PSM_SD_002		